



D6R/75B - Lincat Seal 650 Series Counter-top Rectangular Front Refrigerated Merchandiser - Back-Service - W 750 mm - 0.6 kW

Enhance your food sales by showcasing sandwiches, baguettes, yoghurts, fruit and drinks in the Seal 650 Range Rectangular Front Refrigerated Merchandiser.

- ✔ Using precise thermostatic control this unit holds food from 3°C - 7°C. It enables the user to accurately monitor the temperature of product for the absolute best results
- ✔ Digital display which gives clear indication of temperature to the user
- ✔ The unit is double glazed which keeps the cool air locked in, this in turn gives the customer better results while also saving money through energy efficiency.
- ✔ The provides daylight balanced illumination which lights up the unit giving the product the spotlight
- ✔ Options for self service or back service are also available.
- ✔ Spacious unit enabling you to showcase a wide variety of product

Specifications

Summary Power and Performance

Brand	Lincat	Total Power kW	0.600
Range	Seal	Temperature Range °C	3-7
Series	650 Series	IP Rating	IP33
Power Type	Electric	Temperature Control	Electronic
Unit Type	Counter-top		
Available in UK Only	No		
UK Warranty	2 Years Parts and Labour Warranty		
Export Warranty	Contact your local dealer		
GTIN	5056105104155		

Key Specifications

Number of Shelves included	2
Number of Shelf Positions	2
Refrigerant Type	R452a
Service Type	Back service
Type of Lighting	Fluorescent

Weights and Dimensions Supply Connections

Unit Height (External) mm	965	Requires Installation	No
Unit Width (External) mm	750	Requires Electrical Supply	Yes
Unit Depth (External) mm	650	UK 3 Pin Plug	Yes
Height (Internal) mm	528	Requires Hardwiring	No
Width (Internal) mm	710	Electrical Supply Rating Watts	602
Depth (Internal) mm	570	Single Phase Amps	2.60
Shelf Dimensions Width mm	650	Single Phase Voltage	230
Shelf Dimensions Depth mm	525		
Net Weight Kg	85		

Shipping

Packed Weight Kg	93.5
Packed Height cm	110
Packed Width cm	100
Packed Depth cm	80

Technical Picture

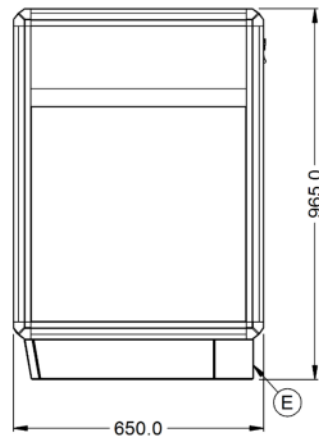
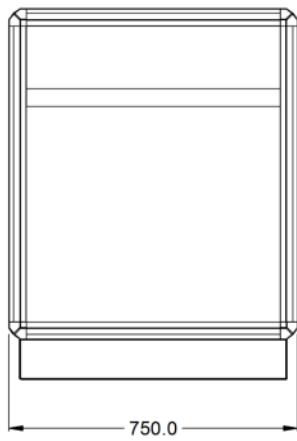
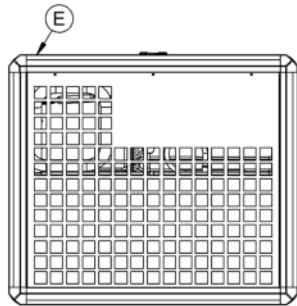



Lincat Limited

Whisby Road,
Lincoln, LN6 3QZ,
United Kingdom

Company No: 2175448

A member company of



Customer Care

Tel: +44 1522 875500
Email: care@lincat.co.uk

Export Customers

Tel: +44 1522 875536
Email: export@lincat.co.uk

Opening Hours

Monday – Friday:
8.30am – 5pm